

Model No.	Parts no. ① ③ ④ ⑥	
	Material	Surface Finish
GRW □□ - S □ B	S50C	Black Dyed
GRW □□ - S □ N		Ni-Plating

GRW06 ~ GRW08

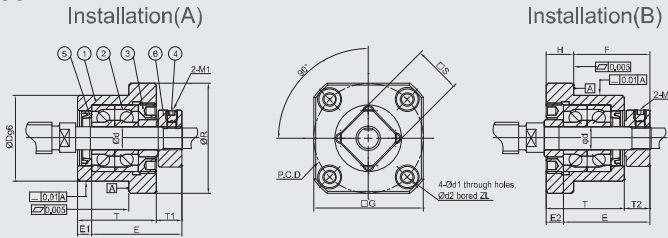

GRW10 ~ GRW25

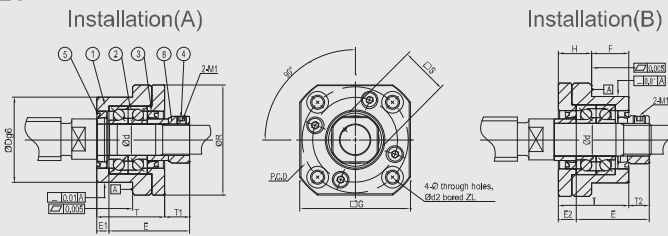

Specification

Standard Type			Dimensions												
Light pre-loaded	Medium pre-loaded	Hard pre-loaded	Ød	ØR	□G	T	H	F	ØDg6	E	Installation(A)		Installation(B)		PCD
											T1	E1	T2	E2	
GRW06-SL □	GRW06-SM □	GRW06-SH □	6	36	28	20	7	13	22 <sup>±0.07</sup> / <sub>±0.05</sub>	22.5	5.5	3.5	6.5	4.5	28
GRW08-SL □	GRW08-SM □	GRW08-SH □	8	43	35	23	9	14	28 <sup>±0.07</sup> / <sub>±0.05</sub>	26	7	4	8	5	35
GRW10-SL □	GRW10-SM □	GRW10-SH □	10	52	42	29	13	16	34 <sup>±0.09</sup> / <sub>±0.05</sub>	29.5	5.5	5	8.5	8	42
GRW12-SL □	GRW12-SM □	GRW12-SH □	12	54	44	29	13	16	36 <sup>±0.09</sup> / <sub>±0.05</sub>	29.5	5.5	5	8.5	8	44
GRW15-SL □	GRW15-SM □	GRW15-SH □	15	63	52	32	15	17	40 <sup>±0.09</sup> / <sub>±0.05</sub>	38	12	6	14	8	50
GRW20-SL □	GRW20-SM □	GRW20-SH □	20	85	68	52	22	30	57 <sup>±0.09</sup> / <sub>±0.05</sub>	52	10	10	14	14	70
GRW25-SL □	GRW25-SM □	GRW25-SH □	25	98	79	57	27	30	63 <sup>±0.09</sup> / <sub>±0.05</sub>	59	13	10	20	17	80

Ordering Example	GRW	10	SL	N	J
	Model No.	Shaft Dia.	Grade/Pre-loaded	Surface finish	Bearing category

GRW-B

GRW-N



Components

No.	Parts	Material	Q'ty
①	Main housing	S50C	1
②	Bearing	SUJ2	1 pair
③	Cover	S50C	1
④	Space ring	S50C	2
⑤	Seal (<Ø8 one seal only)	NBR	2
⑥	Lucknut	S50C	1

- ① ② ③ are in one unit, No disassemble for accuracy concern.
- Bearing filled with proper lithium soap lubricant and sealed.

Recommended processing dimensions of shaft

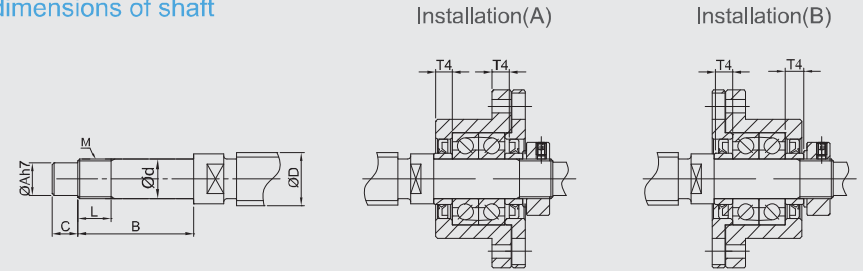

Unit : mm

				Recommended processing dimensions of shaft							
				Ball Screw Shaft O. D.		Shaft End Diameter	Processing sizes of shaft			Nominal thread	
Ød1	Ød2	Z	□S	ØD	Ød	ØA	B	C	M	L	T4
2.9	5.5	3.5	12	8	6 <sup>±0.03</sup> / <sub>±0.02</sub>	4	28	8	M6*P0.75	8	5
3.4	6.5	4	14	10 / 12	8 <sup>±0.03</sup> / <sub>±0.02</sub>	6	32	9	M8*P1.0	10	5.5
4.5	8	6	16	12 / 14 / 15	10 <sup>±0.03</sup> / <sub>±0.02</sub>	8	36	15	M10*P1.0	11	5.5
4.5	8	6	19	14 / 15 / 16	12 <sup>±0.03</sup> / <sub>±0.02</sub>	10	36	15	M12*P1.0	11	5.5
5.5	9.5	6	22	18 / 20	15 <sup>±0.03</sup> / <sub>±0.02</sub>	12	47	20	M15*P1.0	13	10
6.6	11	10	30	25 / 28 / 30	20 <sup>±0.03</sup> / <sub>±0.02</sub>	17	62	25	M20*P1.0	17	11
9	15	13	35	30 / 32 / 36	25 <sup>±0.03</sup> / <sub>±0.02</sub>	20	76	30	M25*P1.5	20	15

\* Supported Side spec refer to P.52~P.53